

© Copyright
This drawing and any design hereon is the copyright of the Consultants and must not be reproduced without their written consent.

All drawings remain the property of the Consultants.

NOTES

LEGEND

Existing Watermain	
Proposed Watermain	
Proposed Sluice Valve	
Proposed Air Valve	
Proposed Fire Hydrant	
Proposed Scour Valve	
Proposed Water Meter	
Proposed Washout Hydrant	
Proposed Boundary Box	
Diverted Trunk Mains	
Site Boundary	

NOTES:

- EXISTING 300mmØ WATERMAIN TO BE RE-ROUTED BETWEEN POINT A AND POINT B. EXACT ROUTE TO BE AGREED WITH IRISH WATER.
- EXISTING 150mmØ WATERMAIN TO BE CONNECTED TO RE-ROUTED 300mmØ WATERMAIN AT POINT C.
- WATER SUPPLY NETWORK FOR THE DEVELOPMENT TO BE CONNECTED TO THE RE-ROUTED 300mmØ WATERMAIN AT POINT D UP TO BOUNDARY BOXES. THE WATER SUPPLY SYSTEM HAS BEEN DESIGNED AND DETAILED IN ACCORDANCE WITH IRISH WATER'S CODE OF PRACTICE FOR WATER INFRASTRUCTURE (IW-CDS-5020-03) AND IRISH WATER'S WATER INFRASTRUCTURE STANDARD DETAILS (IW-CDS-5020-01).
- THE WATER SUPPLY SYSTEM IS TO BE CONSTRUCTED IN ACCORDANCE WITH IRISH WATER'S CODE OF PRACTICE FOR WATER INFRASTRUCTURE (IW-CDS-5020-03) AND IRISH WATER'S WATER INFRASTRUCTURE STANDARD DETAILS (IW-CDS-5020-01).
- CONSTRUCTION OF THE WATER SUPPLY SYSTEM SHALL ENSURE REQUIRED SEPARATION DISTANCES AS SPECIFIED IN SECTION 3.5 AND SECTION 3.6 OF IW-CDS-5020-03.
- WATERMANS TO BE HDPE SDR 17 PIPES IN ACCORDANCE WITH SECTION 3.9 OF IW-CDS-5020-03.
- WATER SERVICE CONNECTIONS TO INDIVIDUAL HOUSING UNITS TO BE 20MM NOMINAL BORE IN ACCORDANCE WITH SECTION 3.9 OF IW-CDS-5030-03.

P04	S4	For Planning	JL	PME	16.04.19
P03	S4	For Planning	JL	PME	27.03.19
P02	S4	For Irish Water Review	JL	PME	07.03.19
P01	S4	For Irish Water Review	JL	PME	06.01.19
Rev.	Suit.	Description	Drawn	Ch'kd	Date

Client

CAIRN HOMES PROPERTIES LTD.

Clients Representative:

BARRY & PARTNERS
consulting engineers

3 Eastgate Road, Eastgate tel +353 21 475 7800
Business Park, Little Island, web www.jbbarry.ie
Co. Cork, Ireland email cork@jbbarry.ie

Project **STRATEGIC HOUSING DEVELOPMENT CASTLETREASURE**

Drawing Title

PROPOSED WATER SUPPLY LAYOUT (SHEET 6 OF 6)

Drawn by:	JL	Date:	11.02.19
Checked by:	PMcE	Date:	11.02.19
Approved by:	TF	Date:	11.02.19
Internal Project REF:	JBB: 18203		
Scales:	1:500 @ A1		
Stage:	PLANNING		

Drawing No.:	18203-JBB-1C-XX-DR-C-0516	Revision	P04	Suitability Code	S4
--------------	---------------------------	----------	-----	------------------	----

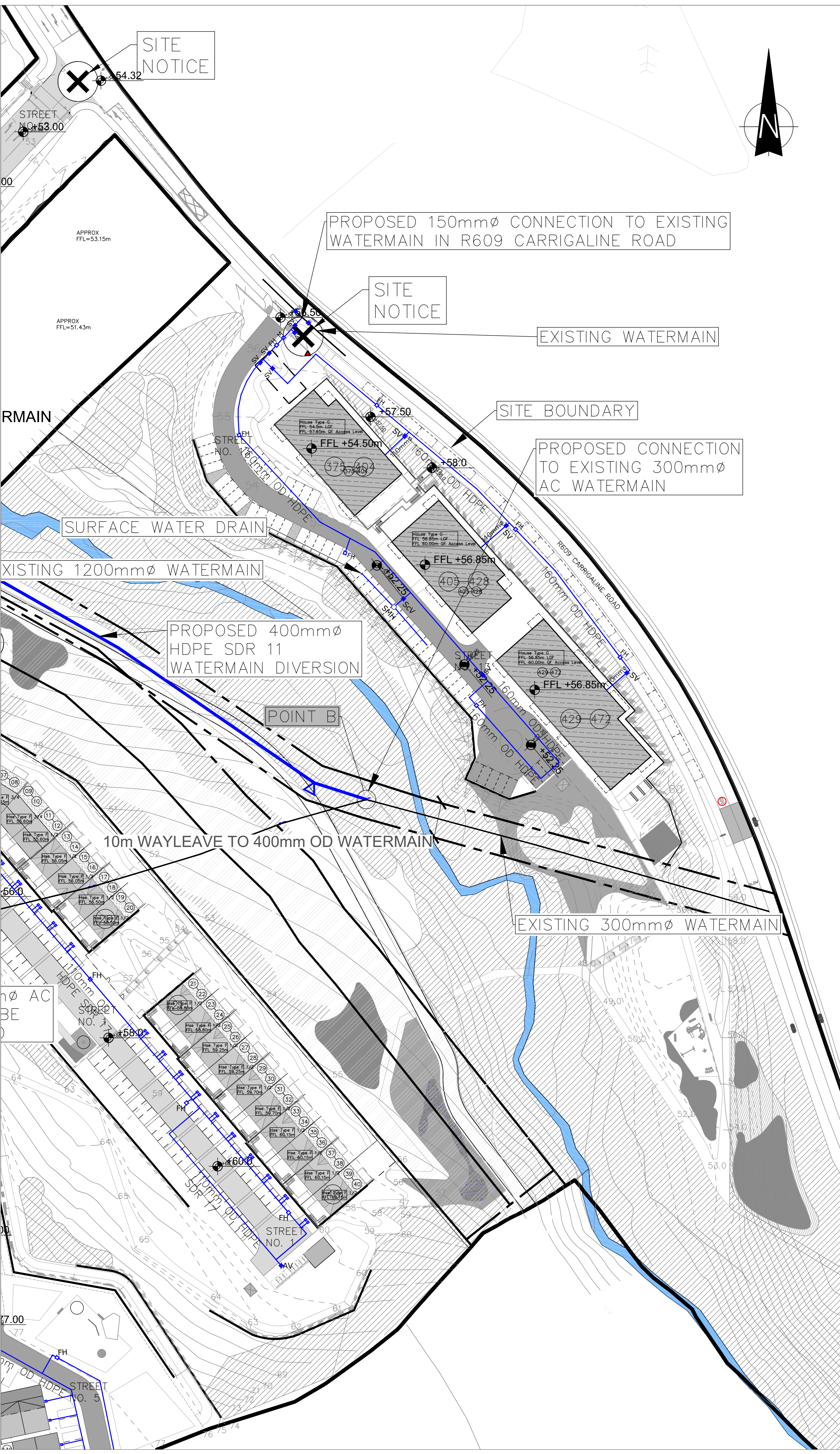

File Name : P:\Barry's Project Files\18 Projects\18203-Cairn Homes Development\100_ Work in Progress\01_Civil\02_Drawings\18203-JBB-1C-XX-DR-C-0516_Proposed_Water_Supply_Layout_Sheet_6_of_6_P04.dwg